

THE POSSIBILITIES ARE ENDLESS



**STEEL
FRAME GARDEN
BUILDINGS**

Email: sales@permaroom.co.uk | Tel: 01773 608808

www.permaroom.co.uk

THE POSSIBILITIES ARE ENDLESS

Permagroup bring to you 'Permaroom'. A range of steel framed buildings that can be used for a wide variety of uses such as garden rooms, offices, leisure facilities, home bars and more!

We specialise in helping clients increase the value and beauty of their homes by creating elegant outdoor living spaces.

We create beautiful bespoke designs by combining seasonal colour, landscaping and your own personal preferences. Our ultimate goal is to ensure that you are completely satisfied with the end results of your project.

STEEL VS TIMBER



Steel is one of the strongest materials used in the industry and is much stronger than timber.



Steel will not burn in a fire like a timber framed building will.



Steel does not rot or allow moisture to sink in, so you won't have any unexpected guests!



Our system allows us to install better insulation, meaning we can fully soundproof your room!

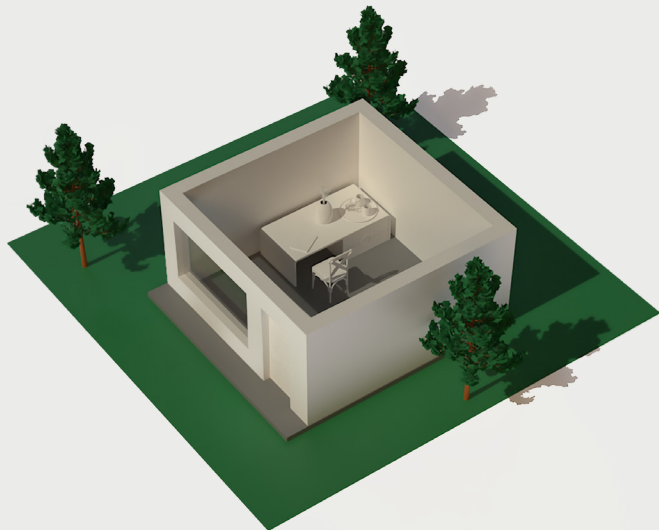

DESIGN CONSULTATIONS

We have in-house design consultations who can produce beautiful 3D images of your garden building. We offer this service **FREE** of charge and will tweak and amend as many times as you need. For your free design consultation, please speak to a member of our team.

CUSTOMER SATISFACTION GUARANTEED

Your satisfaction is our priority and we strive to provide a service we are proud of. We start every project by providing a thorough consultation to understand your goals and the needs of the project. We will provide plans for your approval as well as swatch samples. We do this to guarantee that the project is completed according to your preferences.

www.permaroom.co.uk



**Significant time
saving on site**



**Light gauge
construction steel**



**Highest weight
resistance ratio**



**Accuracy to
within 0.5mm**



**A more
sustainable method**



BEFORE



AFTER



BEFORE



AFTER

Garden rooms are growing in popularity.
We know because we supply this market with EPDM roofs. It was for this reason we decided to look for a premium solution to service this sector.



Key benefits of using a steel frame as opposed to traditional timber

- All frames are made from galvanised steel
- CAD design structures ensuring strength and durability
- Very quick install time, a typical garden room frame can be built in less than 1 hour
- Nothing to rot or encumber any infestation of woodworm
- All sizes in stock and ready for same day collection
- Made from 60% recycled steel
- Fully recyclable

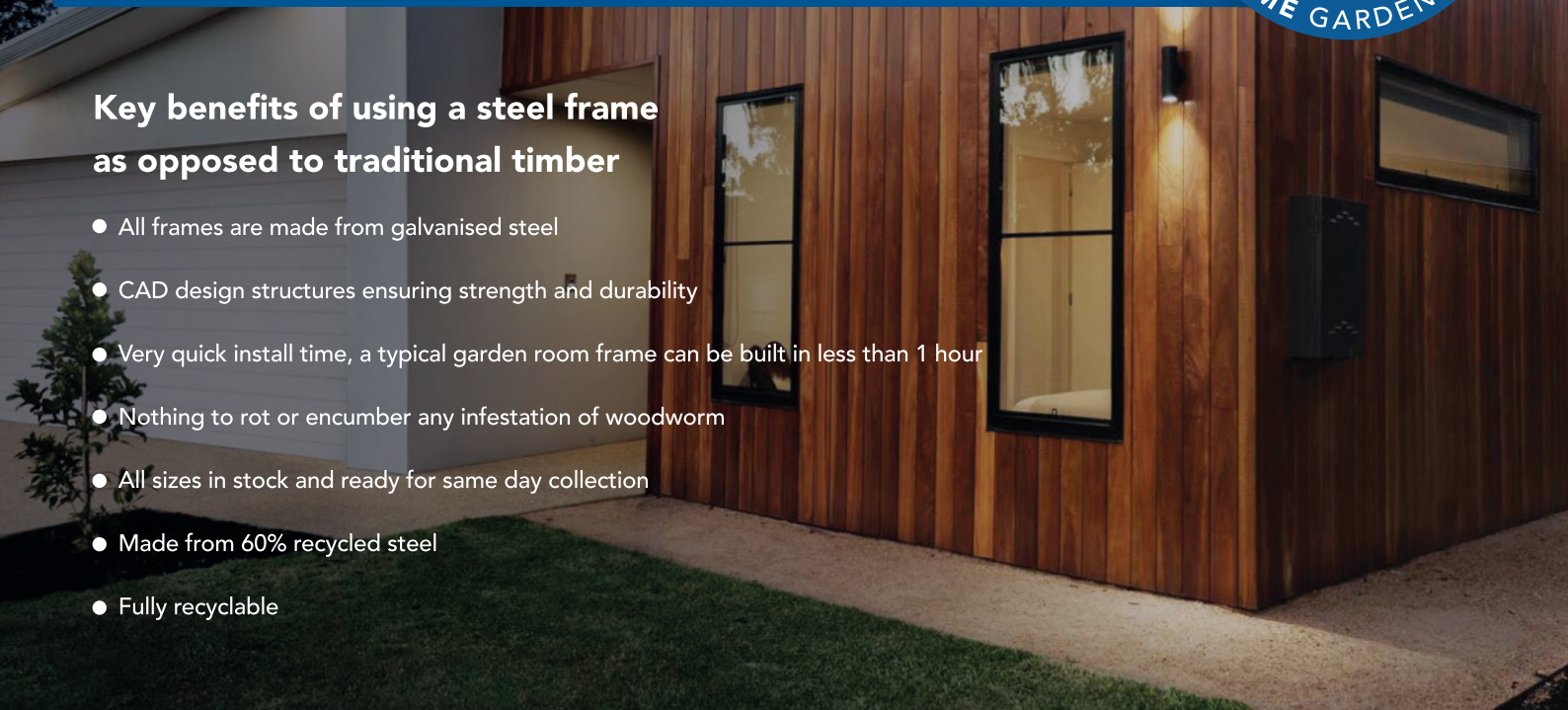



CONTACT US FOR MORE INFORMATION

Email: sales@permaroom.co.uk | Tel: 01773 608808

www.permaroom.co.uk

PermaRoom
Steel Frame Buildings

